

# Actuation

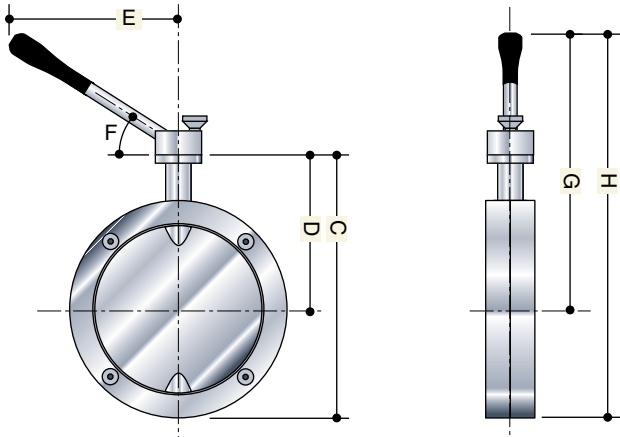

Stainless Steel handle features self locking mechanism in numerous positions.

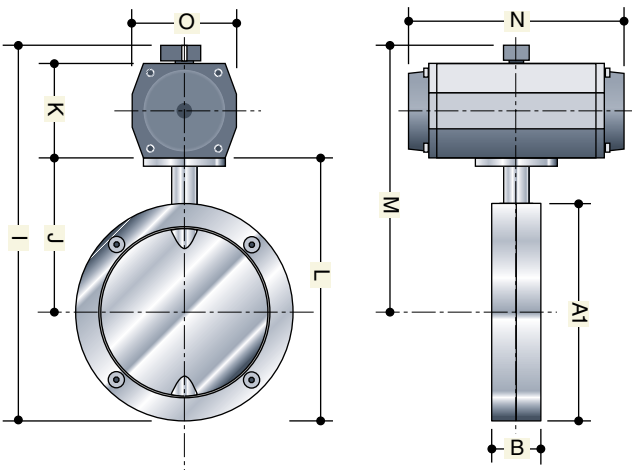

Double acting pneumatic or spring return actuator, stainless steel available

Pneumatic actuators require a minimum of 4 bar or 58 psi

CAM positioner available

Drive systems and modifications available

Removable actuation systems (automatic actuation systems)

## Features

Electropolished finish for best surface cleanliness and minimum resistance to flow

Simple to remove and strip for cleaning particularly with quick release version

Minimal size and weight for easy handling

All 316 stainless steel compact parts

Suitable for use with vacuum and pressure

Sterilization by autoclave

Crevice free GMP acceptable design

Ideal for Powders, granules and pastes

Gasket meeting FDA standard

## Applications

Loading and unloading of process machinery

Outlet valves for containers for powders, pastes and granules used in the pharmaceutical, food, cosmetics and fine chemicals industries

Sterile air control

Nominal Diameter	Actuator		Valve Body (Kg)					
	PNEU	SR	WAF	WQR	QRQR	WQC	QCQR	QRQC
4" (100mm)	40DA	103SR	3.5	3.7	3.9	4.3	4.6	5
6" (150mm)	80DA	200SR	4.8	5.1	5.4	5.8	6.1	6.6
8" (200mm)	80DA	200SR	6.6	6.9	7.1	7.8	8.2	8.7
10" (250mm)	80DA	300SR	10	10.2	10.5	11.5	12.1	12.8
12" (300mm)	80DA	300SR						
14" (350mm)	130DA	500SR						
16" (400mm)	130DA	500SR						

WEIGHTS REFER TO VALVE WITHOUT ACTUATOR

Nominal Diameter	A1	A2	B	C	D	E	F	G	H	I	J	K	L	M	N	O
4" (100mm)	150	180	38	205	130	280	30°	300	375	337	130	100	205	262	162	85
6" (150mm)	200	230	38	255	155	280	30°	350	425	387	155	100	255	287	162	85
8" (200mm)	250	280	38	305	305	280	30°	400	475	437	180	100	305	312	162	85
10" (250mm)	306	330	40	-	-	-	-	-	-	523	213	125	366	370	210	110
12" (300mm)	370	400	40	-	-	-	-	-	-	584	242	125	427	399	210	110
14" (350mm)	420	450	40	-	-	-	-	-	-	633	267	125	477	427	210	110
16" (400mm)	470	500	40	-	-	-	-	-	-	725	292	155	527	527	290	140

ALL DATA SUBJECT TO CHANGE WITHOUT NOTICE